



## III Setup and Preparations

1. Product Components Check
2. Before Setup
3. Product Setup
4. Operation Test after Setup

# 1. Product Components Check

**Wait!**

Please check the contents before setup.

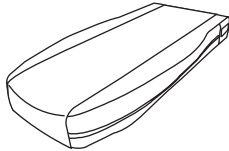

Main Mat

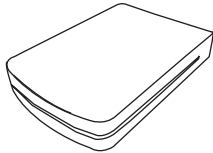

Lower Mat

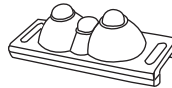

3-Sphere Projector

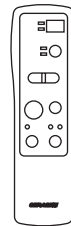

Remote Control

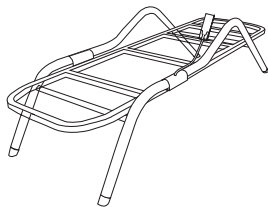

Frame



Power Cord

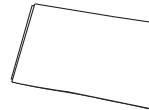

Protective  
Covers

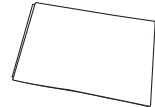

Blanket

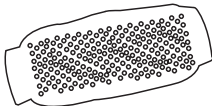

Projector Cover

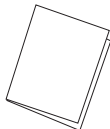

User Manual

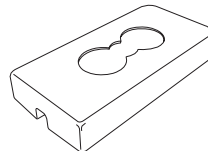

3-Sphere  
Cushion Cover

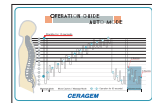

Guide to  
Application  
Points

## 2. Before Setup

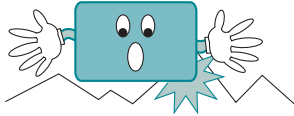

1) Please place the product on a flat surface  
(To prevent any damage to the product).

2) Do not drop the product or apply excessive force  
(To prevent any damage to the product).

.....



3) Do not place the product in humid or dusty location  
(May result in electrocution or fire).

.....



4) Do not place candles, cigarettes, or other flammable materials on the product  
(May result in fire).

.....



5) Do not place beverages, heavy materials, or objects on the "Main or Lower Mat"  
(May result in electrocution, fire, or damage).

.....



6) Do not place the Main or Lower Mat on a bed  
(May deform the product).

.....



7) Be sure to install according to the instructions provided.

## 3. Product Setup

- 1 Attach the protection cloth on the mattress. Place the Main and Lower Mat on the frame and apply the attachment bands.

(To assemble the frame, please refer to the manual found inside the frame box.)

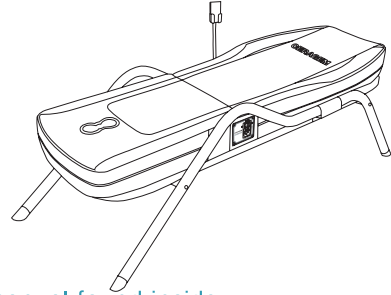

- 2 Locate the power cord, remote control, and external projector provided by the package.

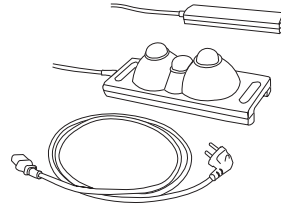

- 3 Place the remote control in the remote control holder and connect it to the remote control connector outlet.

(Properly connect the socket and turn the plug screw until it fastens)

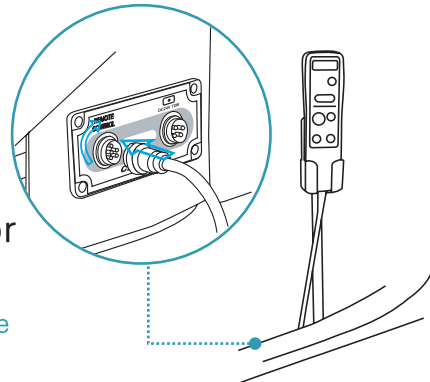

**4** Connect the external projector to the plug outlet via same method as number 3.

(Turning the plug screw when the socket is not properly aligned will cause a malfunction)

※ To attach the 3-Sphere Projector into the Lower Mat, open the zipper of the Lower Mat and insert the 3-Sphere Projector into the allotted space.

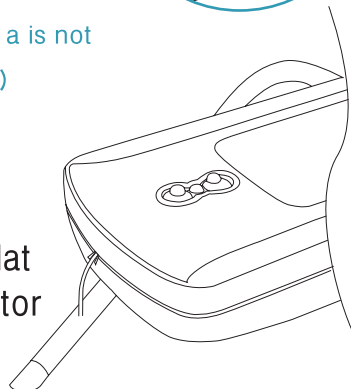
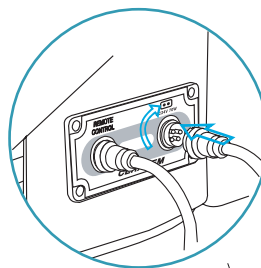

**5** Connect the power cord into the power input outlet of the main Mat and plug it into a power outlet.

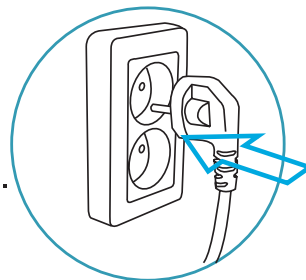

**!** CAUTION

Plugging the power plug when the power switch is ON may cause product malfunction.

## 4. Operation Test after Setup

**1** Turn the power switch ON

※ Please turn off the product after use.

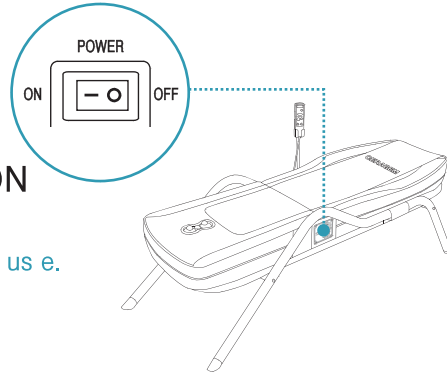

**2** Press the ON/OFF button on the remote control.

If the following indications are displayed on the remote control, it means that the setup was successful and the product is ready for use.

- The current temperature of the internal projector is shown on the temperature display
- AUTO Indicator should be blinking

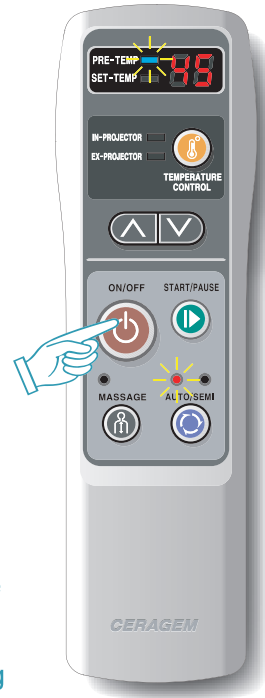

### CAUTION

- 1) Be sure to connect the remote control first before connecting the power cord.
- 2) Set the temperature to the appropriate user level (45~55°C)
- 3) After usage, turn off the remote control and the main power switch.